



xGantry

USER MANUAL
Version 1.0 • May, 2023



The picture is for reference only,the actual product shall prevail

Blank page

Contents

Part 1: Packing List

Part 2: Mechanical Assembly

Part 1 Packing List

Has 4pcs M4X8 screws and 4pcs Profile nuts



2020 Corner Bracket x2



M3 Knurled Screw x2



Screw M4x16mm x4



Screw M3x16mm x4



2040 Corner Bracket x2



M3 Profile Nut x2

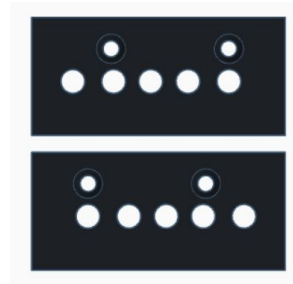

Adapter Plate Pair



Feet



Screw M5x12mm x8



M5 Profile Nut x8



Screw M4x16mm x4

Part 2 Mechanical Assembly

Step 1

Parts Required:

-----Screw M4x20mm X4

-----xTool Gantry

-----Left Adapter Plate

-----Right Adapter Plate

Assemble the Left and Right Adapter Plates to the xTool Gantry using the M4x20 countersunk screws.

Note: The Left and Right Adapter Plates are different

Left

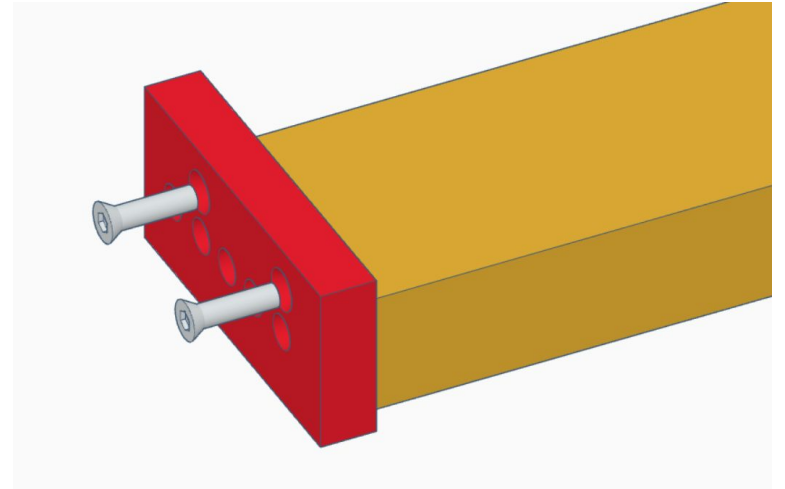

Right

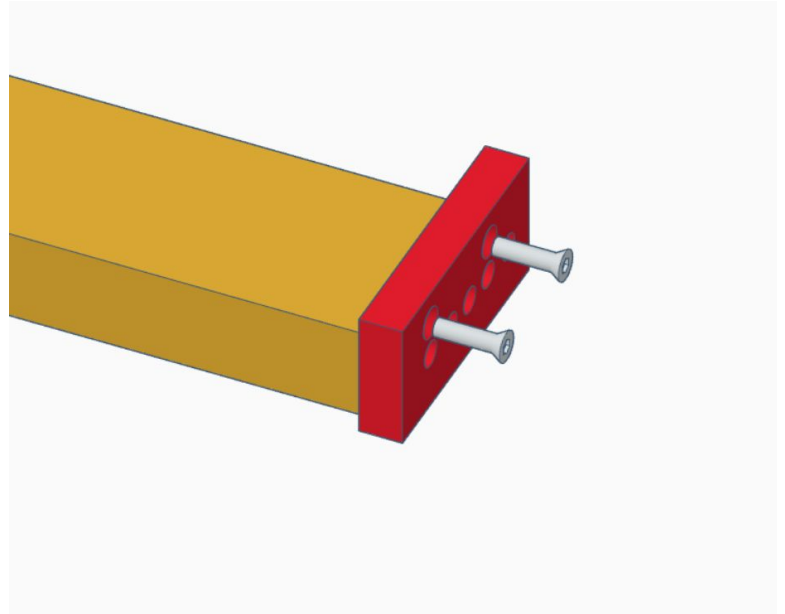

Part 2 Mechanical Assembly

Step 2

Parts Required:

-----Screw M4x20mm X4

-----STEP 1 Assembly

-----2020 trolleys x2

Assemble the 2020 trolleys by installing the M4x20 screws upwards through the trolleys to Left and Right Adapter Plates.

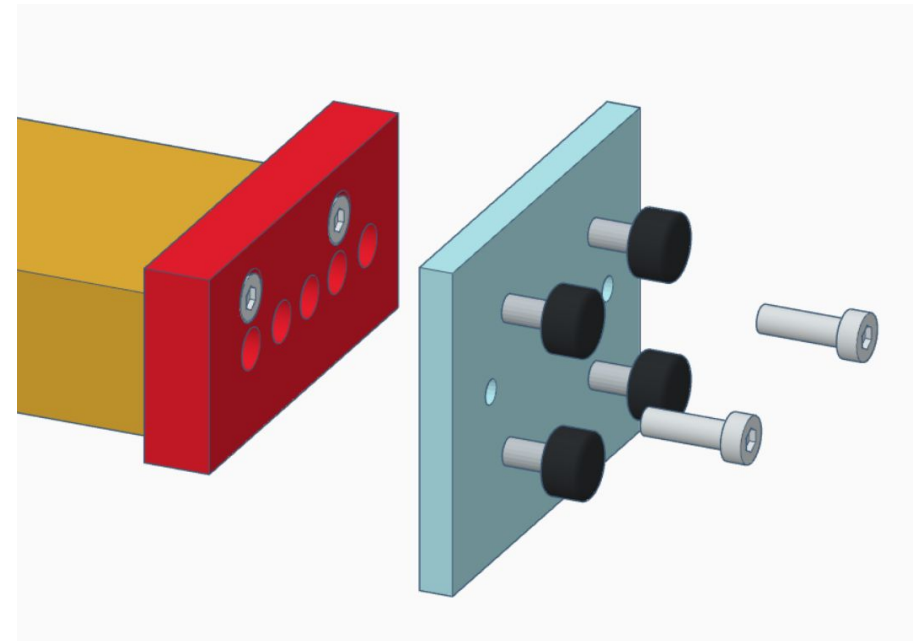
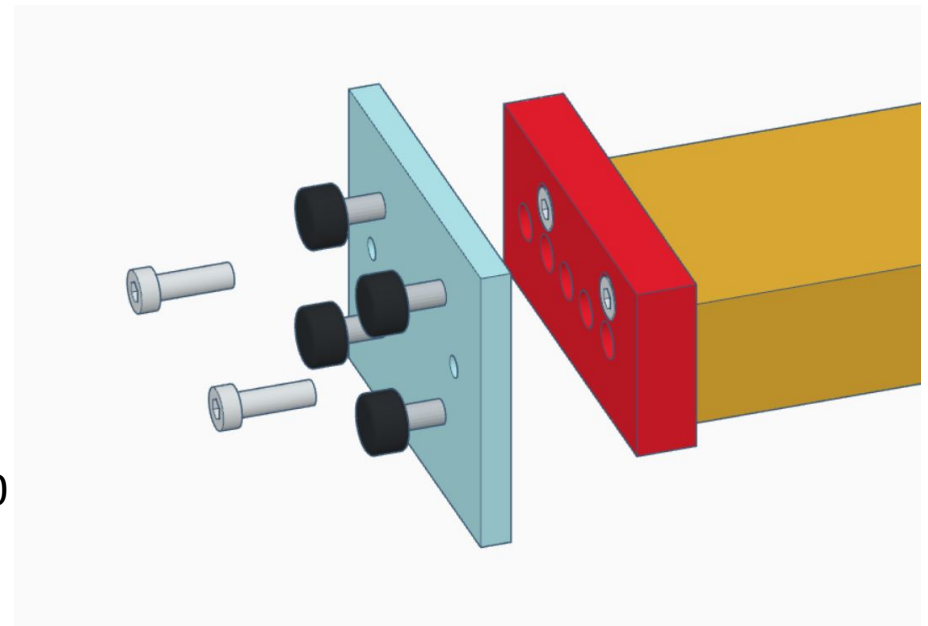

Part 2 Mechanical Assembly

Step 3

Parts Required:

- 300mm 2040 Profile x2
- 2040 Corner Bracket x2
- M5x12 Screw x8
- Profile Nut x8

- Loosely fit four (4) M5x12 Screws and Profile nuts in each 2040 Corner Bracket
- Align Profile Nuts on one side of 2040 Corner Bracket with channels in first 300mm 2040 Profile, and slide corner bracket onto profile
- Lock 2040 Corner Bracket into 60mm from the end of the 300mm 2040 Profile by tightening M5x12 screws
- Repeat for second 300mm 2040 Profile

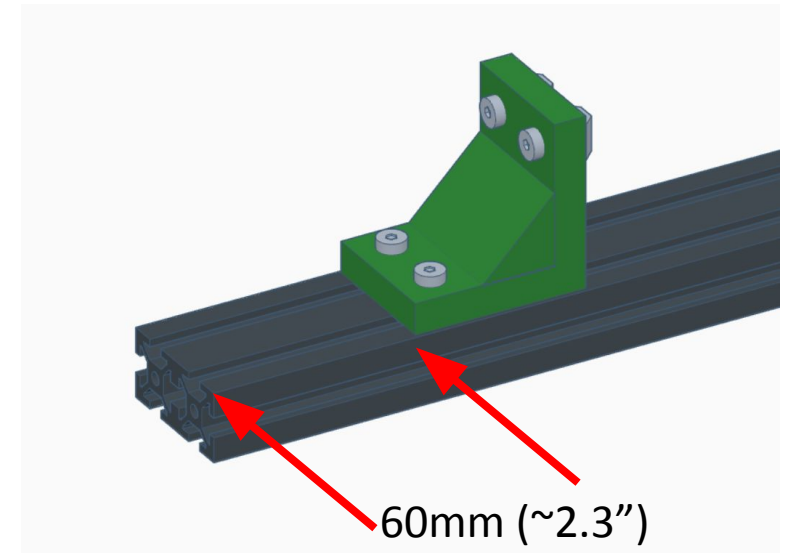
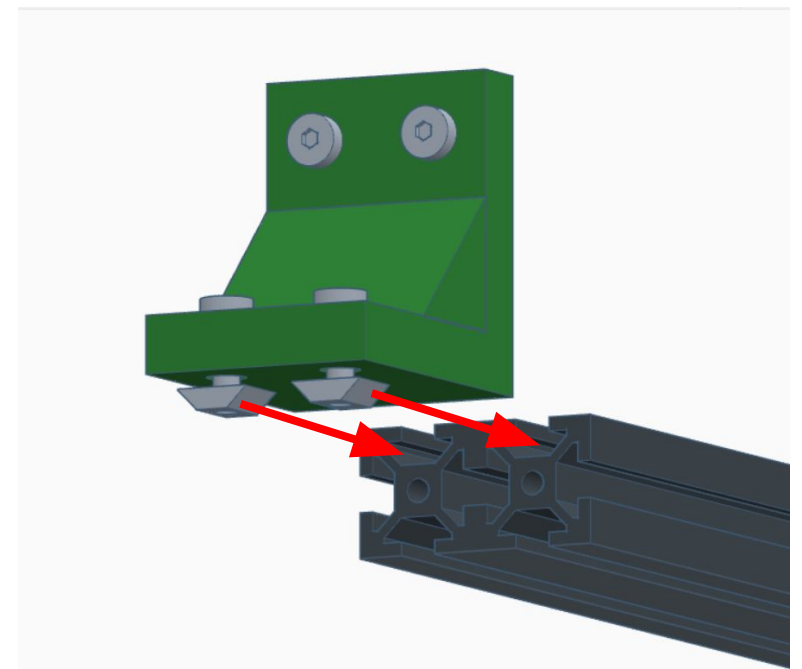

Part 2 Mechanical Assembly

Step 4

Parts Required:

-----STEP 3 Assembly

-----300mm 2040 Profile x2

Attach 300mm 3040 Profile to assembly and lock into position by tightening M5x12 screws

Note: Profiles should form a 90 degree angle

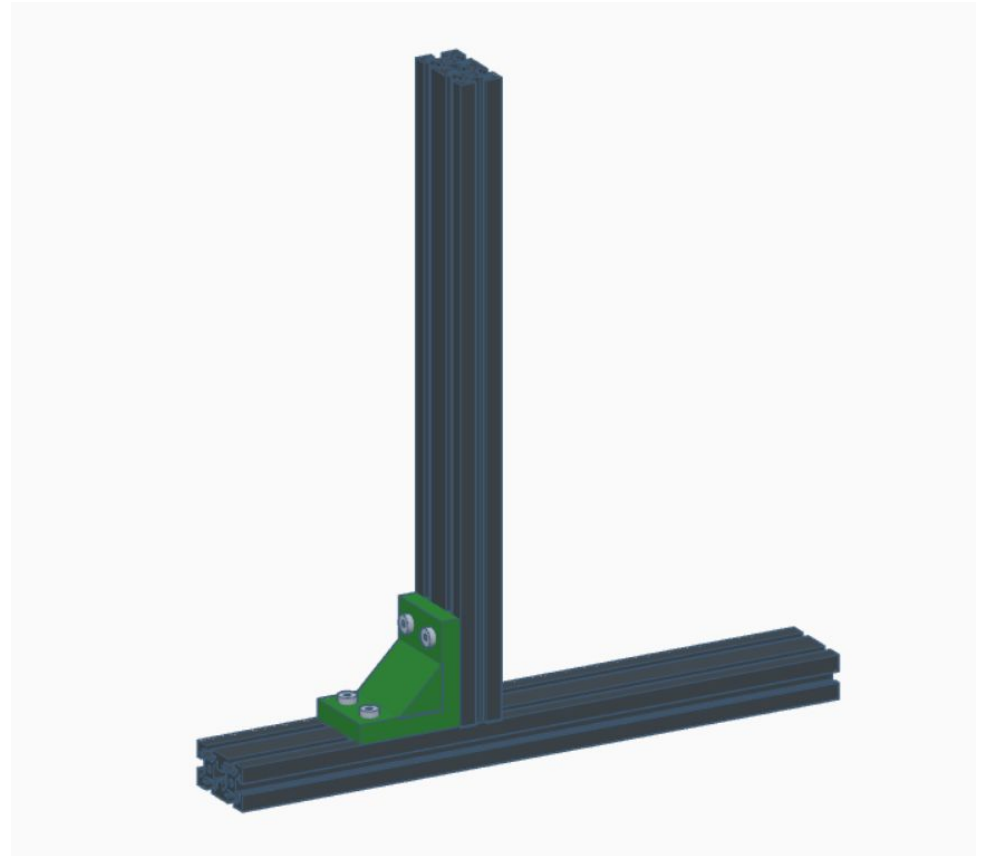

Part 2 Mechanical Assembly

Step 5

Parts Required:

-----STEP 4 Assembly

-----2020 Corner Bracket x2

-----M4x8 Screw x8

-----M4 Profile Nut x8

- Loosely fit four (4) M4x10 Screws and Profile nuts in each 2020 Corner Bracket
- Align Profile Nuts on one side of 2020 Corner Bracket with channels in first Step 4 Assembly, and slide corner bracket onto profile
- Attach 2020 Corner Bracket to assembly to the edges are flush and lock into position by tightening M5x12 screws
- Repeat for second Step 4 Assembly

Note: Brackets will face opposite each other on each assembly

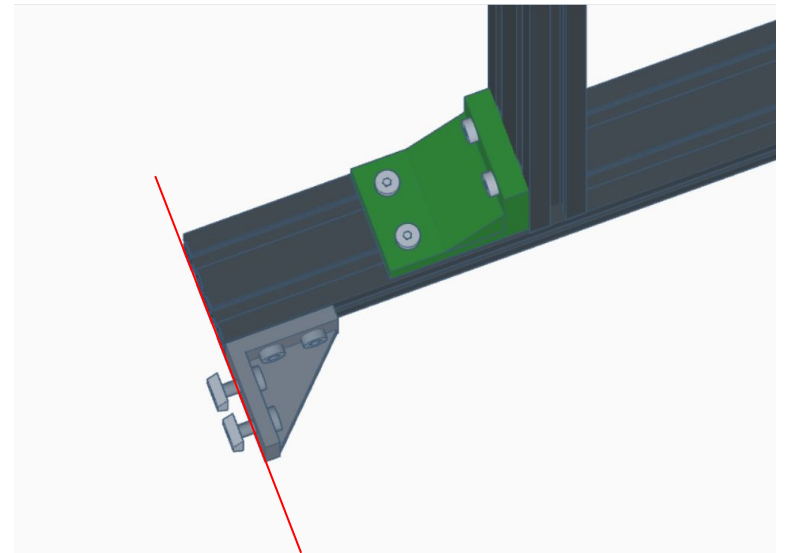
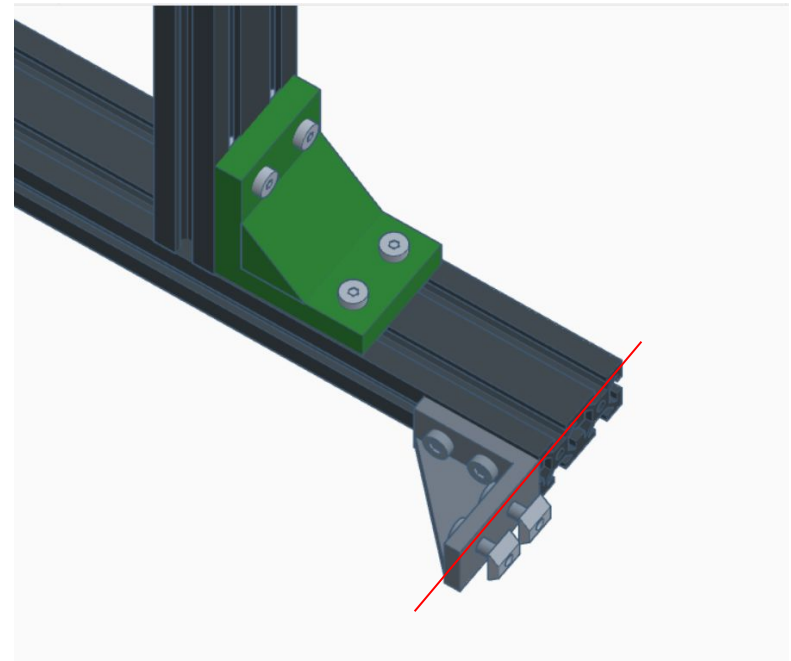

Part 2 Mechanical Assembly

Step 6_{1/2}

Parts Required:

-----STEP 2 Assembly

-----STEP 4 Assembly

- Align Trolley wheels and Lock Screw of Step 2 Assembly with channels in Step 4 Assembly
- Lower Step 2 Assembly as far down Step 4 Assembly as it will go.

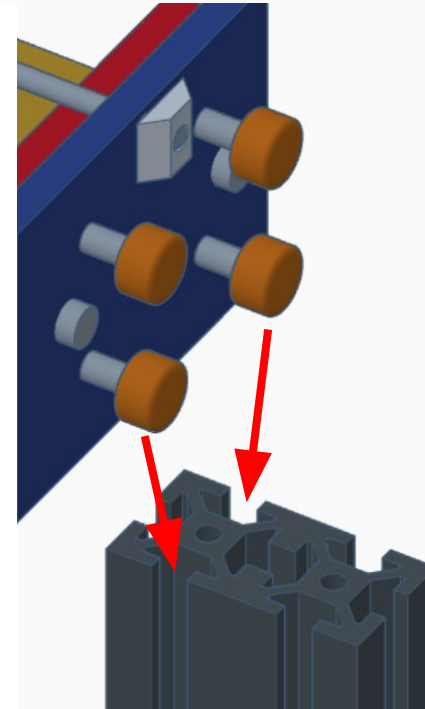
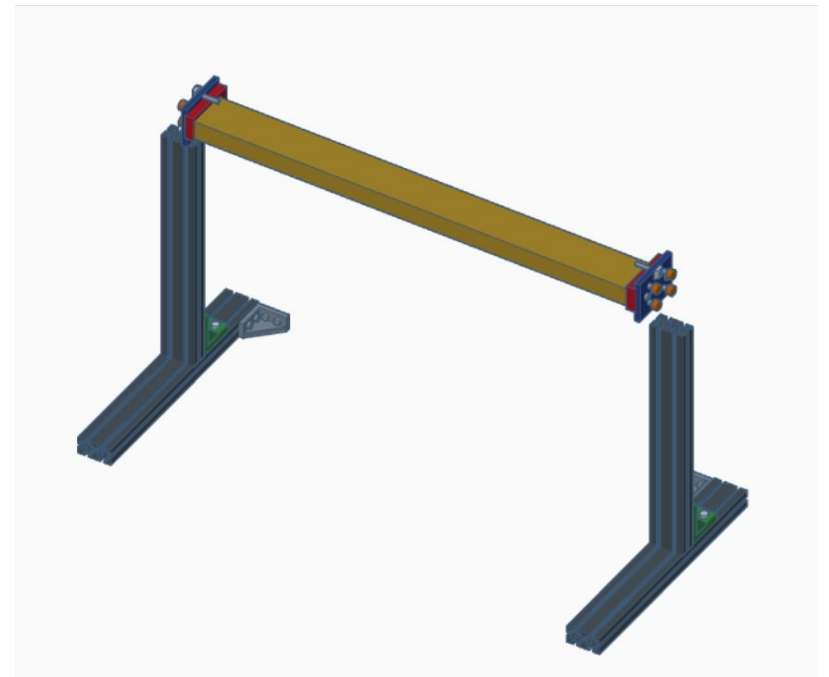
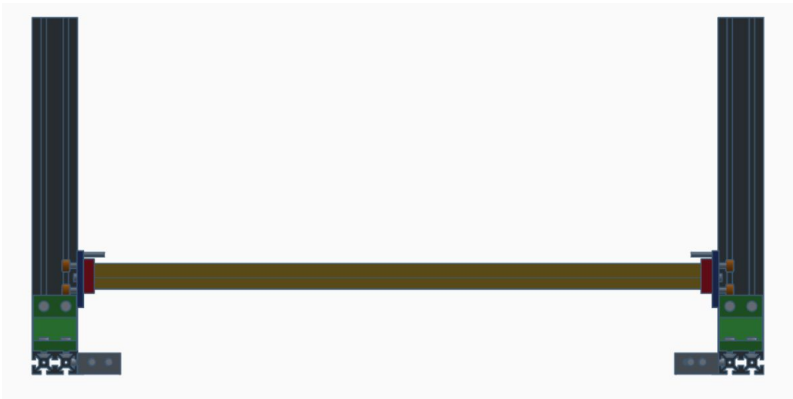

Part 2 Mechanical Assembly

Step 6_{2/2}

If it is difficult to push the wheel into the profile, you can use an open-end wrench to adjust the eccentric nut on the inside of the Trolley. Adjust the eccentric nut to the loosest state when putting, so that the wheel is farthest away from the profile; after putting assembling, slowly rotate and adjust the eccentric nut, until movement is smooth and there is not obvious shaking.

In total, there are four eccentric nuts that can be adjusted, two on each Trolley



Part 2 Mechanical Assembly

Step 7

Parts Required:

-----STEP 6 Assembly

-----650mm 2040

Profile

- Starting on one side, align the Hammer Nuts of the Step 6 Assembly with the channel of the 650mm 2040 Profile
- Slide profile until it is centered on Step 6 Assembly
- Attach profile to assembly by tightening M5x12 screws

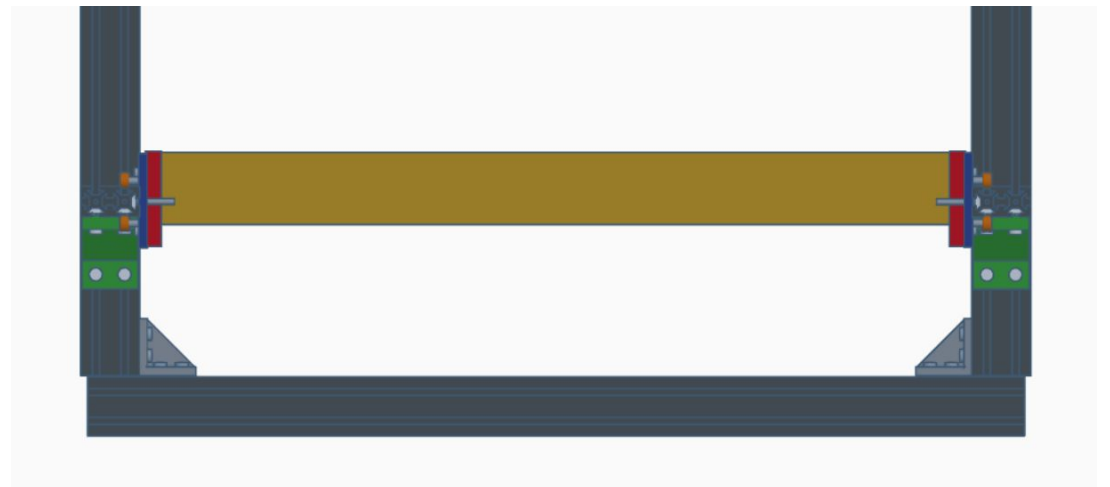
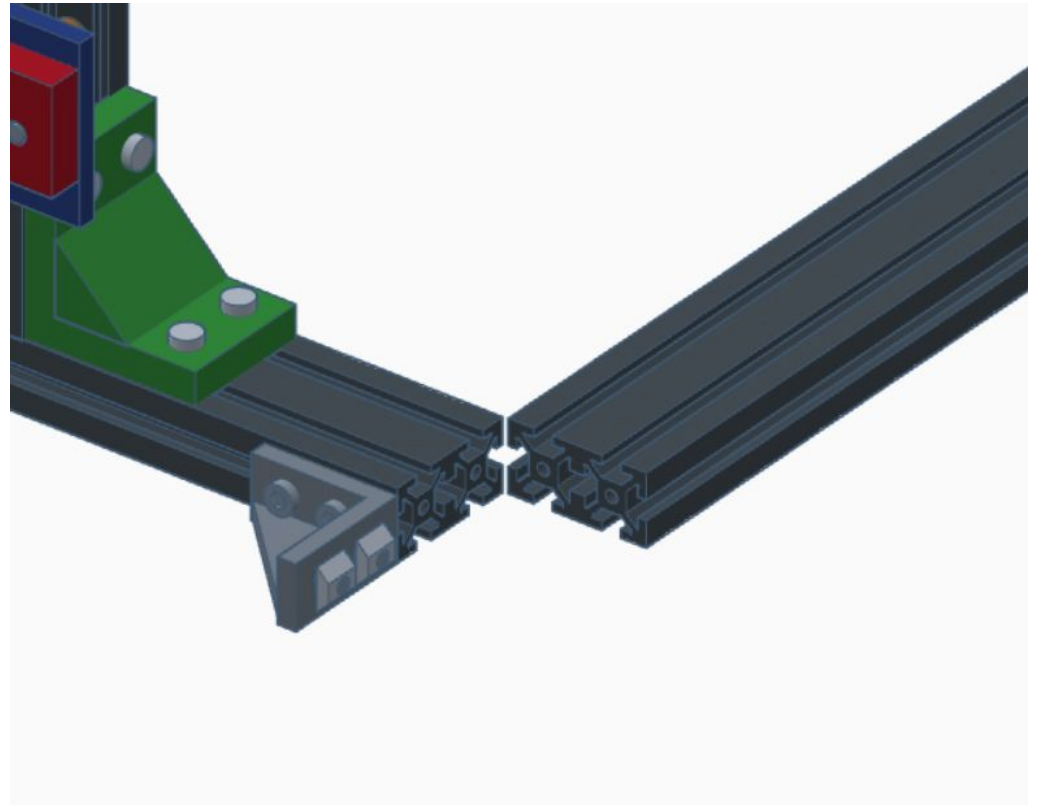

Part 2 Mechanical Assembly

Step 8

Parts Required:

-----xTool Controller

-----Controller Box

-----Controller Lid

-----M3x25 Screw x4

-----Feet x4

- Insert xTool Controller into Controller Box
- Attach Controller Lid to Controller Box with Feet and M3x25 Screw

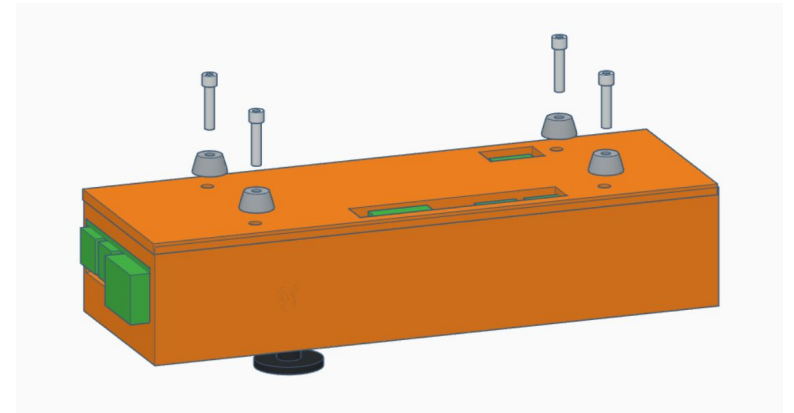
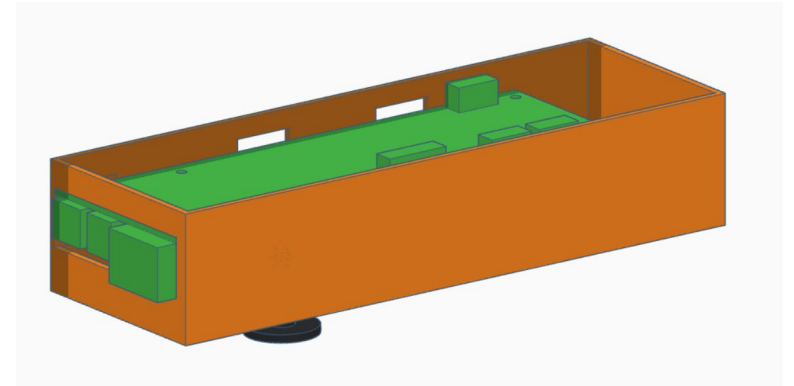
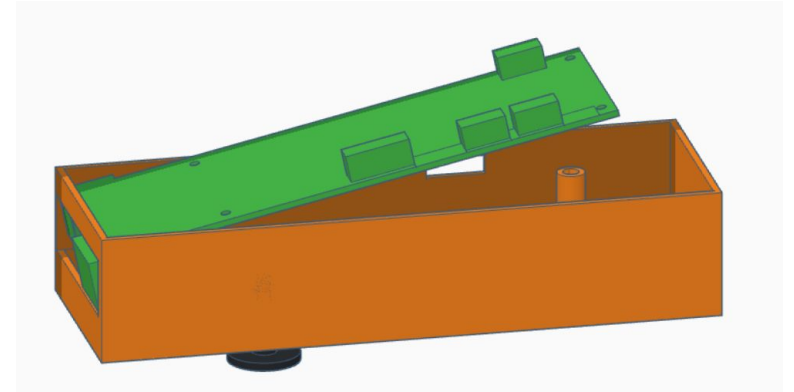
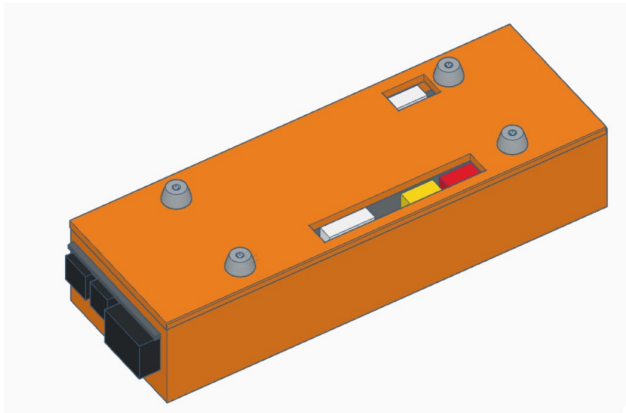

Part 3 Finished!

